

LEGENDA / LEGEND:

- KM kilometraj proiectat / designed chainage
- CP cota proiectata, in m / designed level, in m
- Rv raza curbei de racordare circulare din plan vertical, in m / radius of round junction curve from vertical plan, in m
- Bv bisectoarea curbei de racordare din plan vertical, in m / bisector of junction curve from vertical plan, in m
- Tv tangenta curbei cu raza Rv / tangent of curve with radius Rv
- CP_{ex} cota existenta, in m / exiting level, in m
- NSS nivel superior sina / designed upper level of the rail

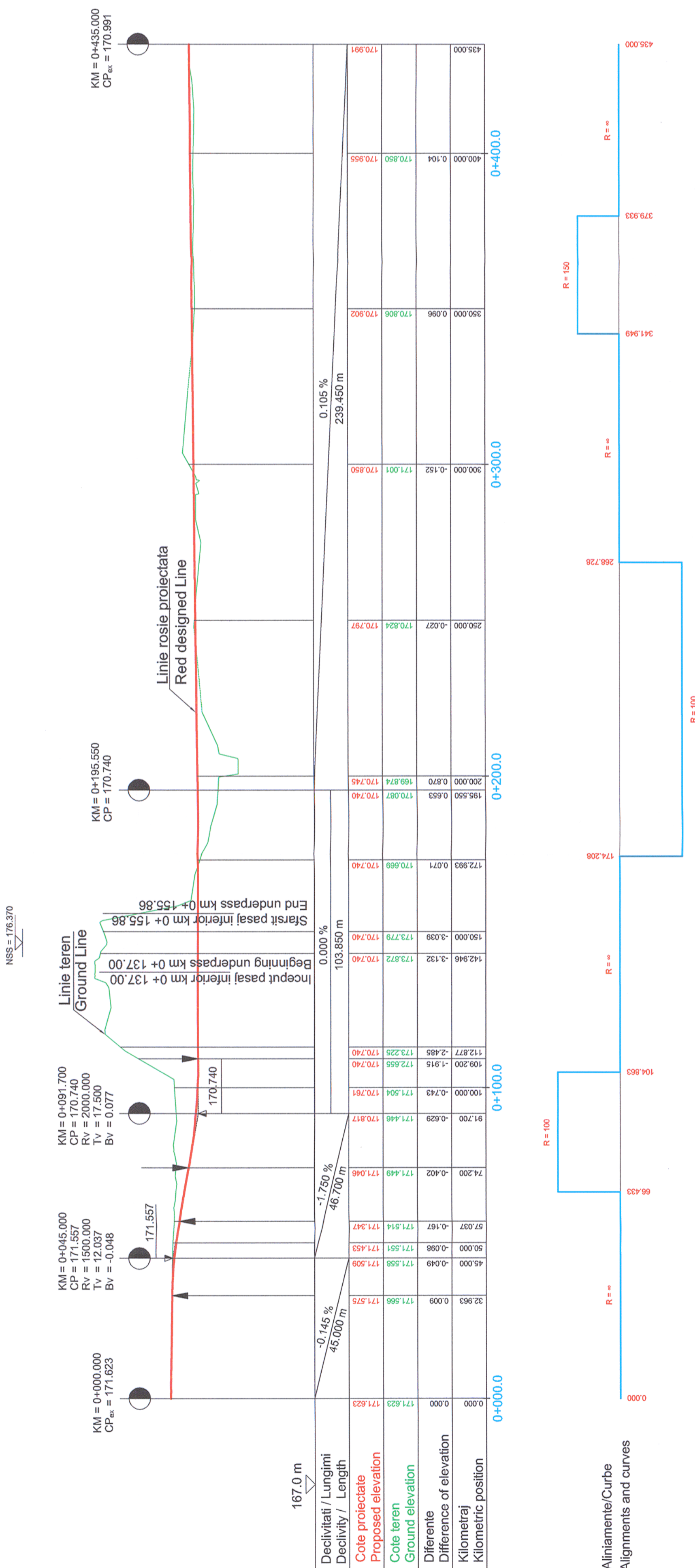

NSS = 176.370

Lineie teren / Ground Line

Linie rosie proiectata / Red designed Line

Aliniamente/Curbe / Alignments and curves

KM = 0+045.000
CP = 171.557
RV = 1500.000
TV = 12.037
BV = -0.048

KM = 0+091.700
CP = 170.740
RV = 2000.000
TV = 17.500
BV = 0.077

KM = 0+195.550
CP = 170.740

KM = 0+435.000
CP_{ex} = 170.991

167.0 m

170.740

171.557

171.557

171.623

171.623

171.623

171.623

171.623

171.623

171.623

171.623

171.623

171.623

171.623

171.623

171.623

171.623

171.623

171.623

171.623

171.623

171.623

171.623

171.623

171.623

171.623

171.623

171.623

171.623

171.623

171.623

171.623

171.623

171.623

171.623

171.623

171.623

171.623

171.623

171.623

171.623

171.623

171.623

171.623

171.623

171.623

171.623

171.623

171.623

171.623

171.623

171.623

171.623

171.623

171.623

171.623

171.623

171.623

171.623

171.623

171.623

171.623

171.623

171.623

171.623

171.623

171.623

171.623

171.623

171.623

171.623

171.623

171.623

171.623

171.623

171.623

171.623

171.623

171.623

171.623

171.623

171.623

171.623

171.623

171.623

171.623

171.623

171.623

171.623

171.623

171.623

171.623

171.623

171.623

171.623

171.623

171.623

171.623

171.623

171.623

171.623

171.623

171.623

171.623

171.623

171.623

171.623

171.623

171.623

171.623

171.623

171.623

171.623

171.623

171.623

171.623

171.623

171.623

171.623

171.623

171.623

171.623

171.623

171.623

171.623

171.623

171.623

171.623

171.623

171.623

171.623

171.623

171.623

171.623

171.623

171.623

171.623

171.623

171.623

171.623

171.623

171.623

171.623

171.623

171.623

171.623

171.623

171.623

171.623

171.623

171.623

171.623

171.623

171.623

171.623

171.623

171.623

171.623

171.623

171.623

171.623

171.623

171.623

171.623

171.623

171.623

171.623

171.623

171.623

171.623

171.623

171.623

171.623

171.623

171.623

171.623

171.623

171.623

171.623

171.623

171.623

171.623

171.623

171.623

171.623

171.623

171.623

171.623

171.623

171.623

171.623

171.623

171.623

171.623

171.623

171.623

171.623

171.623

171.623

171.623

171.623

171.623

171.623

171.623

171.623

171.623

171.623

171.623

171.623

171.623

171.623

171.623

171.623

171.623

171.623

171.623

171.623

171.623

171.623

171.623

171.623

171.623

171.623

171.623

171.623

171.623

171.623

171.623

171.623

171.623

171.623

171.623

171.623

171.623

171.623

171.623

171.623

171.623

171.623

171.623

171.623

171.623

171.623

171.623

171.623

171.623

171.623

171.623